

DIY Knee Wall | (R-16, R-19)

Reflectix® Installation Instructions

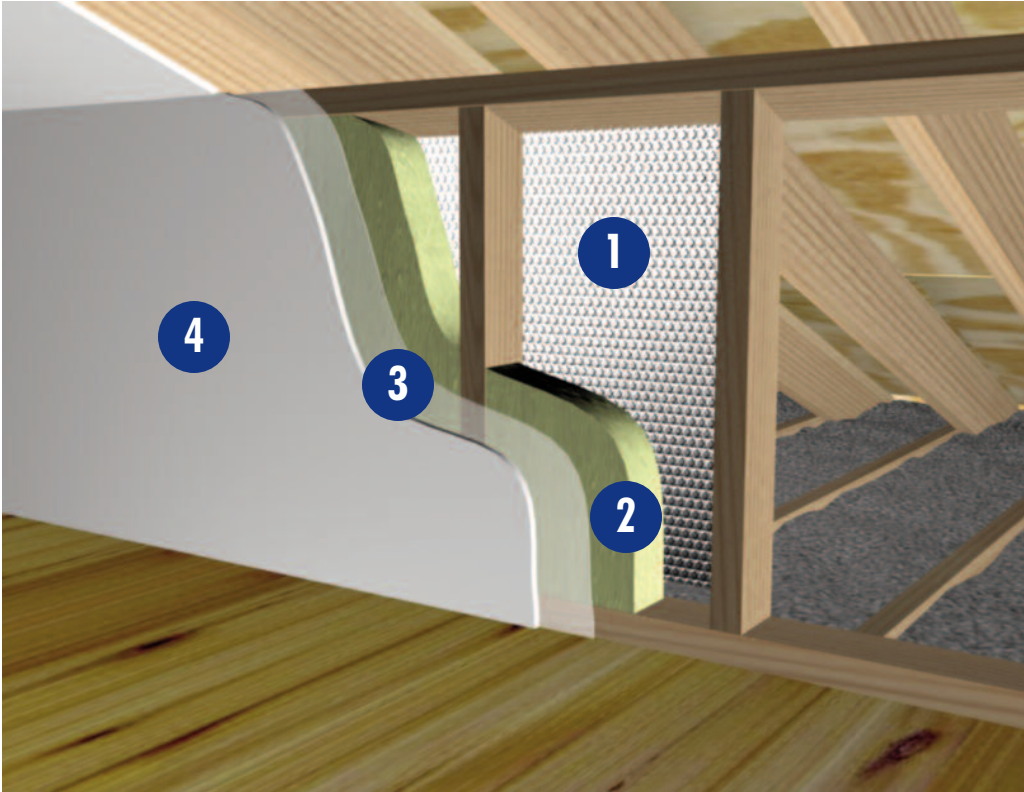

1. Reflectix® Insulation
2. R-13 Fiberglass Batt
3. Vapor Barrier (Polyethylene) if Code Required
4. Interior Panel (Sheetrock)

Tools Required:

- Safety Glasses
- Staple Gun
- Tape Measure
- Utility Knife/Scissors

Recommended Products:

Reflective/Bubble/Bubble/Reflective - Roll: BP24025 (24"x 25')

Staple Tab, Reflective/Bubble/Bubble/Reflective - Roll: ST16025 (16"x 25'), ST24025 (24"x 25')

Installation Instructions: (There are 2 methods with varying levels of benefit)

1. Product Installed in the Back of the Knee Wall Cavity - R-16 and a Radiant Reflector (with R-13 Fiberglass Batt)

- Construct Knee Wall per Building Code.
- Prior to installing fiberglass batts, measure the inside height of the knee wall cavity.
- Precut the Reflectix® to this measured length minus 1/2".
- Start at the inside top of the first cavity.
- If utilizing the Reflective/Bubble/Bubble/Reflective, Staple Tab product, staple the tab of the product to the side of the stud and continue downward stapling every 3" to 4" - Repeat on opposite stud - The plane created by the product should be parallel to the back side faces of the studs - There should be a continuous 1/2" air gap across the bottom of the cavity. >

- If utilizing the Reflective/Bubble/Bubble/Reflective product, staple the edge of the product to the back face of the stud, splitting the stud - Continue downward stapling every 3" to 4" - Repeat on opposite stud - The plane created by the product should be parallel to the back side faces of the studs - There should be a continuous 1/2" air gap across the bottom of the cavity.
- Install Fiberglass Batt per Manufacturer's Instructions.
- Install a Vapor Barrier on the inside of the Knee Wall if your Building Code dictates.
- Finish interior of Knee Wall.

2. Product Installed in the Back of the Knee Wall Cavity - R-19 and a Radiant Reflector (with R-13 Fiberglass Batt and 0.75" furring (on the back of the Knee Wall))

- Prior to placing the Knee Wall and nailing it to the floor and rafters, attach a 1"x 2" (nominal) furring strip to the back of each Knee Wall Stud.
- Install Reflectix® per instruction in Method #1 (above).

Review These Important Safety Guidelines Prior to Installation:

- **ALWAYS** check local building codes before installing Reflectix®.
- **ALWAYS** check the area you are insulating and make any needed repairs. Any worn wiring should be replaced before you begin installing Reflectix®.
- **ALWAYS** make sure work areas are well ventilated and well lighted.
- **ALWAYS** use eye protection when operating a staple gun.
- **ALWAYS** use caution and common sense when using a staple gun. Be aware of where electrical wiring is located. Stapling into a wire can cause severe shock or death. **NEVER** staple into electrical wiring.
- **ALWAYS** be careful when working with large pieces of Reflectix® on windy days.
- When installing Reflectix® on bright sunny days, it is best to wear sun glasses.
- Do not work in areas such as attics when temperatures are too hot.
- Visit our website at www.reflectixinc.com for additional product and installation information.

Please Note:

The intention of these Installation Instructions and 3-D renderings are for the sole purpose of illustrating the correct location and relative position of the Reflectix® products in specific building assemblies. The correct construction methods and techniques are the responsibility of the installer or contractor. The methods outlined are recommendations on location of the Reflectix® products as a guideline. There are no claims on the part of Reflectix, Inc. that these building assemblies are finite standards or meet building code requirements (as they can vary by region).

Reflectix, Inc.

P.O. Box 108, Markleville, IN 46056

Phone: (765) 533-4332 or (800) 879-3645

Fax: (765) 533-2327

E-mail: customerservice@reflectixinc.com